

XEROX®

Technology | Document Management | Consulting Services

Xerox 6050A
Wide Format Printer

Overview



Hardworking. **Flexible.** Easy to use.

Wide-format digital monochrome
printing for **busy CAD environments.**

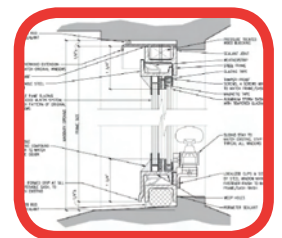
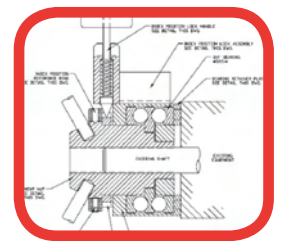

Introducing one of the most **productive workers** in your office.

The Xerox 6050A Wide Format Printer. It's easy to operate, flexible and amazingly efficient. Choose from printer-only or multifunction capabilities in four configurations to fit your needs. Get high-quality monochrome images and exceptional detail on a variety of media. With Xerox FreeFlow® Accxes® Print Server, you can add features and print faster within your current workflow. The Xerox 6050A. Find out what it can do for your busy office.

Turn it on and it goes right to work.

From its speedy warm-up to its ability to multitask, the 6050A is all about productivity:

- Print your first copy in just 19 seconds.
- Print speeds of 7 or 9 D/A1-size prints per minute.
- Scan up to 8 ips while printing for faster completion of jobs (multifunction configuration).
- Holds up to four rolls of bond, vellum, tracing paper or film for true media flexibility.
- Sample Copy feature allows you to preview quality settings and eliminate costly mistakes and reruns.

Get sharp, clear images—print after print.

Your important prints, scans and copies deserve nothing less than superior image quality. Count on sharp, precise detail on even the most complex engineering, architectural and schematic renderings.

- Crisp 600 x 600 dpi printing or 600 x 600 scanning.
- With the optional Wide Format Scan System, copies of even worn originals are improved with automatic background suppression.

The 6050A is upgradeable from 7 to 9 D/A1-size prints and is available in these four configurations:



2-Roll Printer



4-Roll Printer



2-Roll Multifunction



Easy to add toner.



Integrated Xerox FreeFlow
Accxes Print Server.



Familiar Xerox FreeFlow
Accxes print driver enables
a fast learning curve.



Holds up to four rolls for
uninterrupted printing and
media flexibility.

Reliability—day in and day out.

You need a printer that puts in a full day's work, every day. The 6050A's design is built on proven Xerox technology.

Flexibility to fit your office and your process.

Get big functionality in a fully integrated solution. The Xerox FreeFlow Accxes Print Server is compatible with your existing workflow applications.

- Consolidate several functions into one and the 6050A quickly becomes your center for productivity.
- Flexible design fits easily into your workflow, your office or your shop floor.
- The Xerox FreeFlow Accxes Print Server offers big improvements in processing speed, features, functionality and scanning to archive while printing another document set adds to its ability to multitask.
- Complete set of printer drivers for graphics, business, and engineering applications (options for PostScript, PDF, DWF, BMP, JPEG, PNG, GIF and DGN).
- Performance upgrades are as simple as downloading new software features.
- Supports virtually all standard industry peripherals.

Count on Xerox-trained service and customer support.

Xerox supports your entire solution, from printer to media and consumables. A responsive network of service professionals is here to help you make the most of your Xerox solution.

Our guarantee is one of the best in the industry. The Xerox Total Satisfaction Guarantee applies to equipment under a Xerox warranty or Xerox maintenance agreement, subject to certain restrictions.



4-Roll Multifunction

Designed for demanding wide format applications like these:

- Architectural or construction plans
- Architectural or engineering renderings
- Schematics
- Electrical diagrams (e.g., wiring)
- Mechanical 2D
- Solids modeling
- Mechanical 3D
- Scientific/Medical
- Seismic
- GIS/Mapping



For more information on the Xerox 6050A Wide Format Printer, call 1-800-ASK-XEROX or visit us on the web at: www.xerox.com.

Specifications

Print Engine		FreeFlow Accxes Print Server		Space Requirements	
Process/imaging	Xerographic LED	Internal	Integrated Print Server	Width, depth, including trays	
Print engine speed	4.1 ips	Memory	1 GB (max 4 GB)	6050A Printer	
Prints/minute 6050A	7 D (A1); with key, 9 D (A1)	Hard Disk Drive	80 GB or better	128" (3,250 mm), 150.2" (3,815 mm)	
FPOT	19 sec.	Ports	IEEE1394 (scanner only), Serial RS232 (service only) and USB 2.0 (device interface only)	6050A Printer with Scan System	
FCOT	32 sec.	Network protocols	TCP/IP 10/100/1000; LPR; TFTP	Printer: 128" (3,250 mm), 150.2" (3,815 mm),	
FreeFlow Accxes	Max. copies 999	Data formats	Standard: HPGL/2 (HP 750C emulation), HP-RTL (HP 750C emulation), TIFF 6.0 (including LZW), CALS 1&2, CalComp 906/907/951/PCI, FileNET, NIRS, CGM, VCGL, VRF, Versatec Data Standards, Xerox Emulation 150, C4, JPEG	Xerox Scan System (with compact tray): 76.25" (1,936.8 mm), 101" (2,565.4 mm)	
Warm-up time	3 min.		Optional: Adobe® PostScript® 3™, PDF (1.6), DWF, BMP, JPEG 2000, PNG, GIF, DGN	Xerox Scan System (with stacker tray): 103" (2,616.2 mm), 101" (2,565.4 mm)	
Media supply 6050A	1 drawer, 2 rolls	Job Accounting	Account Management Tool (AMT)	NOTE: When the Xerox Scan System shares space with the printer, orientation of the printer and scanner must maintain minimum service space, which is the largest dimension stated for the facing sides.	
	2 drawers, 4 rolls	Applications	FreeFlow Accxes Document Submit, FreeFlow Accxes Document Retrieve, Web Printer Management Tool, Account Management Tool, InstantAccxes		
	Optional Multi-Sheet Feeder	Windows® Printer drivers	XP, 2000, Server 2003, XP x64, Server 2003 x64, Vista, Vista x64		
Output size	Min: 11" (279 mm)	Optional Printer drivers	Adobe® PostScript® 3™ for FreeFlow Accxes, Windows XP, 2000, Server 2003, XP x64, Server 2003 x64, Vista, Vista x64		
Resolution	Max: 36" (914.4 mm)				
Print length maximum	600 dpi				
Grayscale levels	49.2", 590.4" (15 m)				
	256 simulated monochrome only				
Media		Electrical Requirements		Dimensions and Weight	
Media types	Bond, HPH vellum, tracing paper, film	Print Engine	208/240 V, 50-60 Hz, 12 amp	Width, Depth, Height, Weight	
Media weights	Bond: 18–20 lb. (60–110 gsm)	Scan System	110/240 V, 50-60 Hz, 2 amp max	6050A Printer	
	HPH Vellum: 20 lb. (90–112 gsm)	FreeFlow Accxes	110/220 V, 50-60 Hz, 5/2.5 amp max	49.2" (1,250 mm), 25.2" (640 mm), 37" (940 mm), 683 lbs. (310 kg)	
	Tracing paper: 20 lb. (90–112 gsm)			2 Roll—504 lbs. (229 kg)	
	Film: 4 mil (75–100 micron)			4 Roll—670 lbs. (304 kg)	
Scanner System				6050A Printer with Scan System	
Scanner speed	2 ips (51 mm/s) (standard), 4 ips (102 mm/s), 7.3 ips (185.4 mm/s) (optional)			Printer: 49.2" (1,250 mm), 25.2" (640 mm), 37" (940 mm), 683 lbs. (310 kg)	
Scanner resolution	Up to 600 dpi (interpolated)			2 Roll—504 lbs. (229 kg)	
Grayscale	256/24-bit color (optional)			4 Roll—670 lbs. (304 kg)	
Max. doc. input size	42" (1,066.8 mm) width x 100' (30.5 m) (input)			Xerox Scan System: 16" (406 mm), 53" (1,346.2 mm), 45" (1,143 mm), 150 lbs. (68 kg)	
	36" (914.4 mm) width (image)				
Max. doc. thickness	0.5" (12.7 mm)				
Registration	Center				
Electronic collation	999				
Finishing					
Output stacking cap.	100 D (A1)				
Optional High-Cap.	1,000 (mixed size)				
Optional folder	Generic Folder Interface (GFI)				
	Card Interface				

